

STRATHMORE PRESENTS

Discover Strathmore

# A CELEBRATION OF THE GUITAR



SPONSORED BY DEDE AND MARVIN LANG

Monday, February 21, 2011  
11AM-4PM

**FREE!**

No Strollers or  
Pets Allowed



CityDance Classes



Rocknoceros



Nathan Foley



Homemade Jamz' Blues Band



The Sweater Set



Ted Garber

  
**STRATHMORE®**  
AT THE INTERSECTION OF ART AND LIFE®

5301 Tuckerman Lane  
North Bethesda, MD 20852  
www.strathmore.org • (301) 581-5100

Complimentary Parking in the  
Grosvenor-Strathmore Metro Garage.

Strathmore would like to thank the following media  
partners of Discover Strathmore

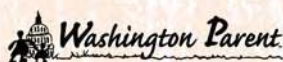

Welcome to

Discover Strathmore

# A CELEBRATION OF THE GUITAR



## CONCERT HALL MARRIOTT STAGE

11AM

### Take A Bow

See how it feels to take a bow on the Concert Hall stage to full applause!  
11-11:45AM

12PM

### Levine Showcase: Nathan Foley and Guitar Orchestra

First, experience the Brazilian and African sounds of the 8-member Levine Guitar Orchestra, then listen to 17 year-old Nathan Foley, a guitar virtuoso who has multiple Apollo Theater wins, with a Levine faculty band.  
12-1PM

1 PM

### Homemade Jamz' Blues Band

Featuring Ryan, Kyle & Taya Perry  
"These young kids have got energy, talent and do the blues proud with their own flavor. I believe they've got a GREAT future ahead." - B.B. King  
1:15-2PM

2 PM

### Homemade Jamz' Blues Band

A repeat performance by Ryan, Kyle & Taya!  
2:15-3PM

3 PM

### Rhodes Tavern Troubadours

This roots-rock group performs their hits with their signature big guitar sound!  
3:15-4PM

4 PM

## LOBBY ACTIVITIES



### LOCKHEED MARTIN LOBBY

#### Luthier Demonstrations

Kevin Enoch, banjos  
Steve Carmody, guitars  
Robert W. McCluskie, violins  
Walter Messick, dulcimers  
Bruce Jacob, electric guitars  
11AM-4PM

### COMCAST CIRCLES LOUNGE

Arts, Crafts & Games  
with Mary Jane Campbell  
11AM-4PM

### GRAND TIER LOBBY

Face Painting  
Masquerade Face and Body Art  
11AM-3PM



## EDUCATION CENTER

Rehearsal Room 402

### Ted Garber, singer-songwriter

Watch as "One Man Band" Ted Garber, armed only with an acoustic guitar, a voice and some harmonicas, uses current electronic music gadgetry to "loop" hand percussion, drum beats, bass lines, rhythm grooves and blistering solos into a full-sounding, self-sun accompaniment. 11:15AM-12PM

### DIY String Band

The DIY String Band makes music out of junk, homemade instruments (and even a few store bought ones). Bruce Hutton, Cathy Fink, Marcy Marxer and Maureen Andary will entertain and inspire you with sing-alongs, tap-alongs and clap-alongs.  
12:15-1PM

### Back Porch Blues

Blues masters Jay Summerour, Rick Franklin and Eleanor Ellis perform Piedmont blues for guitars and harmonica.  
1:15-2PM

### The Sweater Set

This folk/pop duo utilizes guitar, ukulele, flute, accordion, glockenspiel, kazoo's, hand percussion and their voices on their tunes. Take a whimsical tour through the instruments, harmonies of their songs in a hybrid performance/discussion.  
2:15-3PM

### Back Porch Blues

Blues masters Jay Summerour, Rick Franklin and Eleanor Ellis perform Piedmont blues for guitars and harmonica.  
3:15-4PM

## EDUCATION CENTER

Studio 405

### CityDance Conservatory/Select in Concert

A concert for the whole family, featuring dances from Blues to Ballet.  
11:30AM-12PM

### CityDance Conservatory/Select in Concert

A concert for the whole family, featuring dances from Blues to Ballet.  
12:30-1PM

### CityDance Conservatory/Select in Concert

A concert for the whole family, featuring dances from Blues to Ballet.  
1:30-2PM

### CityDance Conservatory/Select in Concert

A concert for the whole family, featuring dances from Blues to Ballet.  
2:30-3PM



This whole season, Strathmore's **GUITAR FESTIVAL** celebrates the most influential musical instrument of the 20th century—along with its cousins: the lute, Chinese pipa, and mandolin. Through June 2011, the **GUITAR FESTIVAL** welcomes classical, jazz, rock and experimental guitarists from across the country and around the world in concerts, classes and special events. Please see [www.strathmore.org](http://www.strathmore.org) for a complete schedule of events.

We hope you enjoy the classes, performances and demonstrations throughout the Music Center and Mansion today. **If you need any assistance, just look for Strathmore staff and volunteers in the blue shirts.**



Please note: free tickets are required for these classes. Tickets will be distributed 30 minutes prior to the start of each class. Line forms behind the ticket office outside the back door of the education wing.

EDUCATION CENTER Dance Studio Room 304 (No Shoes Allowed)	EDUCATION CENTER Room 309	MANSION AT STRATHMORE	MANSION AT STRATHMORE Music Room
<p><b>It's Electric!</b> <b>The Magic Strings of Dance</b> (Ages 12 and under) 11–11:20AM</p>		 <p>Esther Nisenthal Krinitz, <i>We Will All Perish</i></p>	<p><b>11AM</b></p> <p><b>Mark Jaster and Sabrina Mandell</b> Hilarious family-friendly Marcel Marceau inspired mime. 11–11:15AM</p>
<p><b>Hott Guitar Hip Hop</b> (All Ages) 11:35–11:55AM</p>		 <p>Susan Maldon Stregack, <i>Portrait of Henry Greenbaum</i></p>	<p><b>12PM</b></p> <p><b>Electrified: The Guitar Revolution</b> A 45-minute movie on the history of the electric guitar with an introduction by Monica Smith, Exhibition Program Manager of the Lemelson Center for the Study of Invention and Innovation. The film is a Smithsonian Networks production. 11:15AM–12PM</p>
<p><b>It's Electric!</b> <b>The Magic Strings of Dance</b> (Ages 12 and under) 12:10–12:30PM</p>	<p><b>Levine: The Poetry of Music</b> Faculty artist Mary Findley and her students will perform movements from Bach's works for solo violin interwoven with poetry recited in many languages by Levine students. 12–1PM</p>	<p><b>GALLERIES</b> <b>Fine Art Exhibitions:</b> <b>Fabric of Survival</b> &amp; <b>Portraits of Life</b> 11AM–4PM</p>	<p><b>1PM</b></p> <p><b>Baltimore Mandolin Quartet</b> Presented by the Baltimore Symphony Orchestra. Enjoy romantic melodies from Italy and beyond as this "quartetto romantico" performs music old and new on two mandolins, mandola and guitar. A total of thirty strings creates a warm, room-filling sound. 12:15–1PM</p>
<p><b>Hott Guitar Hip Hop</b> (All Ages) 12:45–1:05PM</p>		<p><b>Guided tours by Bernice Steinhardt, daughter of Esther Nisenthal Krinitz of Fabric of Survival.</b> 11:30AM, 1:30PM, 2:30PM, 3:30PM</p>	<p><b>2PM</b></p> <p><b>RTTs</b> Bop along to this kid-friendly performance by the RTTs in their signature roots-rock style...with big guitar sound! 1:15–2PM</p>
<p><b>It's Electric!</b> <b>The Magic Strings of Dance</b> (Ages 12 and under) 1:20–1:40PM</p>		<p><b>SUN PORCH</b> <b>Make a Fiber Art Fabric Collage</b> (Ages 4 and up) 11AM–3:30PM</p>	<p><b>3PM</b></p> <p><b>Rocknoceros</b> One of the area's favorite kid-rock bands rocks the Mansion. 2:15–3PM</p>
<p><b>Hott Guitar Hip Hop</b> (All Ages) 1:55–2:15PM</p>			<p><b>4PM</b></p> <p><b>Michael Rosman</b> A command return engagement by this comedian-juggler. 3:15–3:45PM</p>
<p><b>It's Electric!</b> <b>The Magic Strings of Dance</b> (Ages 12 and under) 2:30–2:50PM</p>		<p><b>LIBRARY</b> <b>Make a Homemade Steel Guitar</b> (Ages 8 and up) 11AM–3:30PM</p>	
<p><b>Hott Guitar Hip Hop</b> (All Ages) 3:05–3:25PM</p>			
<p><b>It's Electric!</b> <b>The Magic Strings of Dance</b> (Ages 12 and under) 3:40–4PM</p>			

# MAP OF STRATHMORE

## ORCHESTRA LEVEL—1st floor

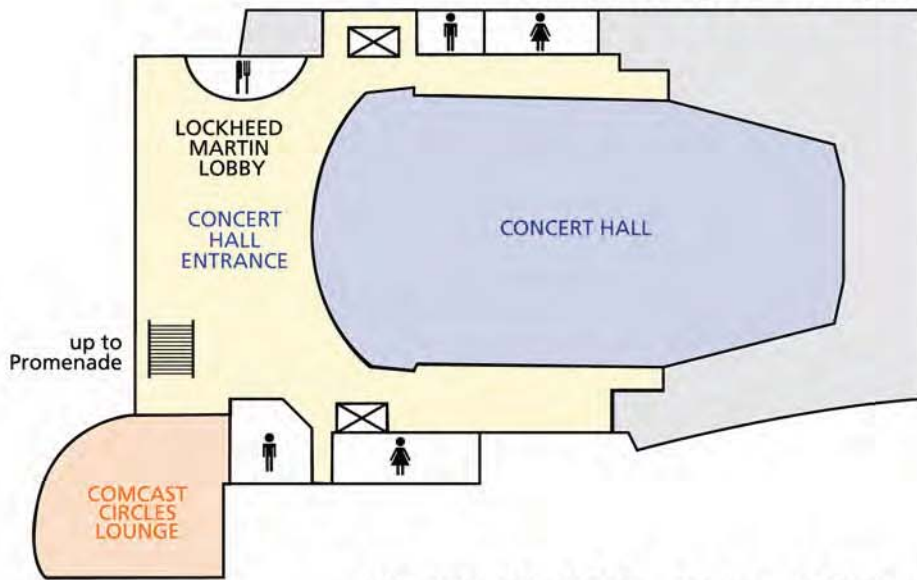

## EDUCATION CENTER—4TH FLOOR

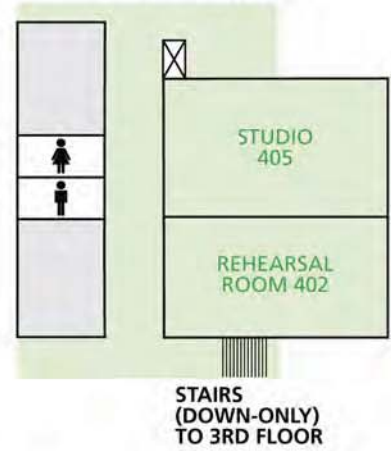

## PROMENADE LEVEL—3rd floor (Main Entry Level)

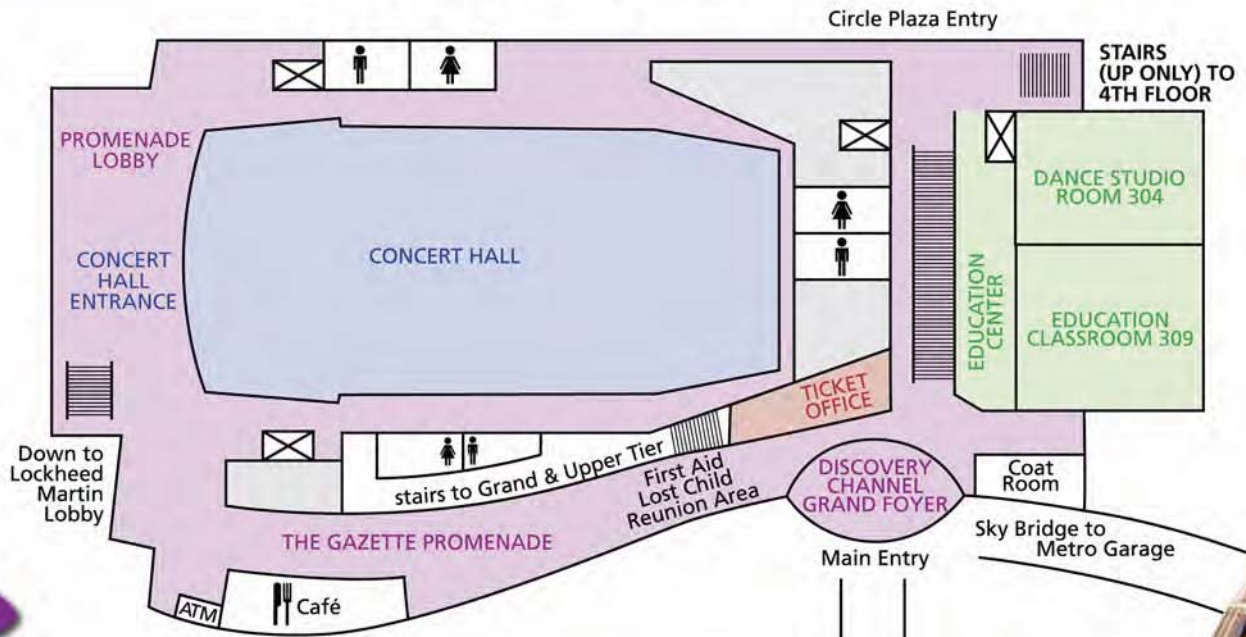

## MANSION AT STRATHMORE

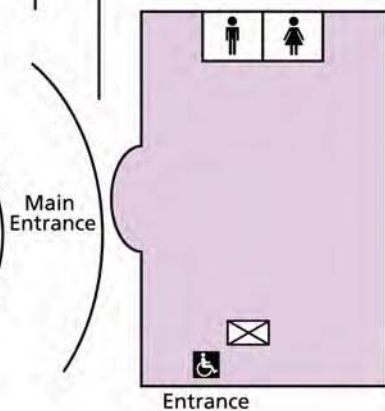

-  Elevators to all levels
-  Staircase
-  Restrooms
-  Refreshments

